

# Casa Americana

Single-Family Houses in Latin America



Birkhäuser





1 Detail of the porch

2 Section

3 Façade

*Opposite page: Porch facing north*

2

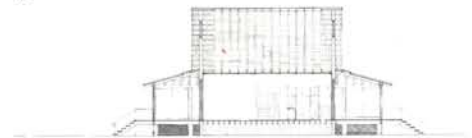

3





- 1 Porch facing east
- 2 Central living room
- 3 Main bedroom

2





## Florida House

Miami, Florida, United States  
1993-1995

### María de la Guardia / Teófilo Victoria

Client: *Natasha Gottlieb / Francisco de Paula Victoria*

Architecture: *De la Guardia Victoria Architects / Trelles-Cabarrocas Architects*

Photography: *Southern Living, Inc. / Silvia Martin, photographer*

This house—inspired directly by Florida's vernacular cracker-style traditions—is in a semi-rural area, south of Miami. Making use of the more commonly available materials, this form of architecture, proposed in the case of this building as a project to evoke memory of the site, responds to the climatic conditions by using wide surfaces of shadow and intermediate space with simplicity.

The building is raised on stiles, thus enabling its easy identification as a space within the space, a refuge which contrasts harmoniously with the site's natural aggressive environment. A relatively solid body in the interior of the house is arranged symmetrically, enfolded by a ring of sheltered galleries which sets a quiet area apart for contemplation of the surrounding scene. The expressive use of both components creates a silhouette which is integrated, recognisable, family-orientated and of serene aspect; its most noteworthy feature being the centre with a high gable roof, covered with metal sheeting from the ridge down to the shallower eaves over the porches. The industrial pieces of regular and predetermined sizes serve to bring out the severe simplicity of the traditional architecture as well as to emphasise the subtle abstraction of forms and proportions. Thus by incorporating less conventional materials and a convincing mathematical order; a timeless atmosphere is given to the geometric regularity of the figures proposed as referential marks for the construction of memory.

In the interior, the central body is developed in a system of clearly defined spaces, articulated in a dense rhythm of compartments opening directly onto the porches. The contrast between the masonry walls of the main areas and the wooden partition walls in the bedrooms (the only closed spaces to invade the continuity of the perimeter galleries) makes plain the different authority of the parts in the silent and deliberate way which characterises the proposal as a whole.

